



THE PULI
HOTEL AND SPA



THE PULI HOTEL AND SPA 璞麗酒店

1 ChangDe Road, JingAn District, Shanghai 200040 China

中国上海市静安区常德路1号 邮政编码200040

T +86 21 3203 9999 F +86 21 3251 8989

information@thepuli.com

reservations@thepuli.com

www.thepuli.com

www.urbanresortconcepts.com



LOCATION

The PuLi Hotel and Spa is China's first luxury urban resort, centrally located in the very heart of Shanghai's JingAn District, between the famous NanJing West Road and YanAn Middle Road. The 26-floor hotel has a prime location close to some of Shanghai's best business, shopping, sightseeing and entertainment areas and is accessible via a myriad of transportation options, including subway Line 2 connecting Shanghai Pudong International Airport and Hongqiao Airport, and Line 7.

The views from The PuLi Hotel and Spa take in the greenery of JingAn Park and it is conveniently located next to the multi-use development Park Place. Park Place is a business landmark on NanJing West Road comprising a premium office tower, the Réel Shanghai Department Store and The PuLi Hotel and Spa.

The PuLi Hotel and Spa is managed by Urban Resort Concepts. It is a member of The Leading Hotels of the World.

DIRECTIONS

- The PuLi Hotel and Spa is located 50 kilometres from Shanghai Pudong International Airport. A 45-minute drive from the airport, drive along the Main Expressway via LuPu Bridge to YanAn Highway. Exit at HuaShan Road.
- The PuLi Hotel and Spa is located 14 kilometers from Hongqiao International Airport. A 25-minute drive from the airport whilst the Shanghai Railway Station is also a 25-minute drive.
- Subway Line 2 connects both Shanghai Pudong International Airport and Hongqiao Airport. Alight at JingAn Temple station for direct access to the Réel Shanghai Department Store at Park Place.
- The Maglev High Speed Train from Pudong International Airport takes you to LongYang Road station on subway Line 2. Take this to JingAn Temple station, which will give you direct access to the Réel Shanghai Department Store.

AWARDS & ACCOLADES

- #2 of "Top 10 Hotels in Asia/China" by *Condé Nast Traveler's Readers' Choice Awards* 2019
- One Michelin Star Restaurant by *The Michelin Guide Shanghai* 2017-2020
- Four-Star Rated Hotels 2019 by *Forbes Travel Guide*
- Top 25 Hotels in China / Top 25 Luxury Hotels in China by *TripAdvisor Travellers' Choice Awards* 2019
- Top 10 Hotels in China by *Condé Nast Traveler's Readers' Choice Awards* 2018
- Top 25 Best Luxury Hotels / Top 25 Best Service Hotels in China by *TripAdvisor Travelers' Choice Awards* 2018
- Top 25 Best Luxury Hotels in China by *TripAdvisor Travelers' Choice Awards* 2017

位置

璞麗酒店是中国最早定位为“都会桃源”的奢华酒店，坐落于上海最繁华的市中心“静安区”，位于南京西路与延安中路之间的常德路1号。酒店拥有优越的地理位置，毗邻众多甲级写字楼、顶级购物中心、观光景点及娱乐场所。酒店所在位置交通便捷，直通地铁2号线与7号线静安寺站。其中地铁2号线贯穿上海浦东国际机场和上海虹桥国际机场。

酒店环抱静安公园的怡人景色，并连接静安区的地标——越洋广场，此顶级商用综合项目由甲级办公楼、芮欧百货与璞麗酒店三个独立项目组合而成。

璞麗酒店是由 Urban Resort Concepts (URC) 酒店管理公司经营管理，同时也是美国立鼎世酒店集团公司 (The Leading Hotels of the World) 的成员之一。

交通

- 璞麗酒店距离上海浦东国际机场约50公里。沿机场高速直达卢浦大桥，并从延安高架华山路出口驶出，车程仅45分钟。
- 璞麗酒店距离上海虹桥国际机场约14公里，车程仅25分钟。同时距上海火车站也仅25分钟车程。
- 地铁2号线连接上海浦东国际机场和上海虹桥国际机场，抵达静安寺站，直通越洋广场内的芮欧百货。
- 上海浦东国际机场磁悬浮高速列车抵达龙阳路站，换乘地铁2号线到达静安寺站，直通芮欧百货。

奖项和荣誉

- 《Condé Nast Traveler》2019读者之选“亚洲/中国十佳酒店”大奖第二名
- 《米其林上海指南》米其林一星餐厅 2017-2020
- 《福布斯旅游指南》2019年度酒店四星奖
- TripAdvisor 2019年度世界旅行者之选中国排名前25位酒店大奖及中国排名前25位奢华酒店大奖
- 《Condé Nast Traveler》2018年中国十佳酒店
- TripAdvisor 2018年度旅行者之选中国排名前25位最奢华酒店大奖及前25位最佳服务酒店大奖
- TripAdvisor 2017年度旅行者之选中国排名前25位最奢华酒店大奖

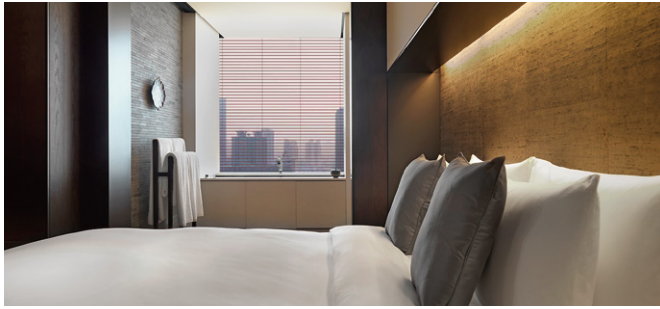

ACCOMMODATION

- 193 rooms and 36 suites
- Flat screen LED television sets
- Bang & Olufsen BEOPLAY M5 wireless speaker
- Nespresso machines
- Personal safes
- Wifi throughout the hotel
- Rainforest showers
- Bathtubs with stunning views over the Shanghai skyline and JingAn Park
- Automated sunshades, temperature adjustments and monitor system in every room
- Stocked mini-bars

CLUB BENEFITS

- Daily breakfast at PHÉNIX eatery & bar, Long Bar, your guest room or on the go
- Check-in and check-out flexibility ¹
- 24-hour dedicated Guest Service specialist
- Choice of non-alcoholic welcome drink
- Soft drinks, coffee and tea all day at Long Bar
- Afternoon tea from 14:30 to 17:30 at Long Bar
- Evening cocktails and canapes at PHÉNIX bar from 17:00 to 19:00
- Fully stocked mini-bar with daily replenishment
- Mini-bar with daily replenishment
- Daily in-room aperitif
- Daily laundry or pressing service ²
- 2-hour use of private meeting room ³
- Priority reservations at PHÉNIX eatery & bar, Long Bar and UR SPA
- One reward night for every 10 paid club room stays
- Daily RMB300 food and beverage credit
- 10% off limousine transfers
- 15% off Personal Training service
- 10% off Health Club retail items
- 20% off UR SPA treatments

Terms and conditions:

- ¹ Early check-in and late check-out guests should provide a valid flight carrier with arrival/departure time at the time of reservations. Hotel reserves the right to offer alternative room type before check-in time for early arrivals and after check-out time for late departures.
- ² Guests are entitled to daily laundry or pressing service of up to 3 pieces per room. Dry Cleaning is excluded.
- ³ Use of private meeting room for up to 10 guests, two hours daily. Advance booking is required and this benefit is subject to availability.

Above privileges are extended on a per-person basis, as determined by the room rate; for single occupancy rate, benefits extended for one guest, and for double occupancy rate, benefits are for two guests.

| Room Category | Size | No. of Rooms |
|------------------------|---------|------------------|
| Corner Deluxe King | 45 sqm | 18 |
| Deluxe King | 45 sqm | 54 |
| Deluxe Twin | 45 sqm | 19 |
| Grand Room | 47 sqm | 84 |
| Grand Studio | 52 sqm | 15 |
| Junior Suite | 50 sqm | 13 |
| Deluxe Suite | 85 sqm | 17 |
| 2-bedroom Junior Suite | 102 sqm | 3 (× 2 bedrooms) |
| Grand Suite | 95 sqm | 2 |
| JingAn Suite | 130 sqm | 1 |

客房及套房

- 193间客房和36间套房
- 高画质平面液晶电视
- Bang & Olufsen BEOPLAY M5 无线扬声器
- Nespresso全自动咖啡机
- 个人专属保险箱
- 酒店提供无线宽带网络
- 热带雨林淋浴房
- 浴缸紧邻落地玻璃窗，可饱览静安公园怡人景致及上海优美城市景观
- 每间房均配备自动遮光帘及高智能室内恒温节能操控系统
- 房价包含迷你吧

璞麗汇专享

- 每日早餐（可选斐霓絲餐厅酒吧、长吧、客房送餐或外带盒）
- 灵活提前入住及延迟退房 ¹
- 24小时专属客户服务专员
- 自选迎宾软饮料
- 全天于长吧享用软饮、咖啡和茶
- 14:30 至 17:30 于长吧享用下午茶
- 17:00 至 19:00 于斐霓絲餐厅酒吧享用晚间鸡尾酒及特制精巧小食
- 客房迷你吧（每日补充一次）
- 每日客房开胃酒配送
- 湿洗及熨烫服务 ²
- 可使用会议室2小时 ³
- 优先预订斐霓絲餐厅酒吧、长吧及遥水疗
- 每累计10次付费入住璞麗汇客房可奖励入住1房晚
- 每日人民币300元酒店餐饮消费额度
- 豪华轿车接送服务九折优惠
- 私人健身教练服务八五折优惠
- 健身中心零售商品九折优惠
- 遥水疗各项目八折优惠

相关条款和条件:

- ¹ 提前入住最早自09:00始，延迟退房最晚至21:00止。若您需要提前入住或延迟退房，须于预订时提供抵达及出发日航班信息。酒店保留为满足宾客提前入住及延迟退房需求而提供安排其他房型的相应权利。
- ² 在您的入住期间可享受有每日高达3件湿洗或熨烫服务。此项目不包含干洗及加急洗衣服务。
- ³ 在您的入住期间可享有每日两小时的会议室使用权，仅限10人或以下的小型会议。会议室需提前预订，并视乎酒店当天会议室实际出租率情况而定。

以上礼遇以实际支付登记入住璞麗汇的人数及费用计算；单人登记入住并支付单人费用，一人获享礼遇；双人登记入住并支付双人费用，两人获享礼遇。

| 客房类别 | 客房面积 | 客房数目 |
|--------|---------|-----------|
| 高级大床房 | 45 平方米 | 18 |
| 豪华大床房 | 45 平方米 | 54 |
| 豪华双床房 | 45 平方米 | 19 |
| 经典客房 | 47 平方米 | 84 |
| 经典豪华客房 | 52 平方米 | 15 |
| 特级套房 | 50 平方米 | 13 |
| 豪华套房 | 85 平方米 | 17 |
| 双卧特级套房 | 102 平方米 | 3 (× 2卧室) |
| 经典套房 | 95 平方米 | 2 |
| 静安套房 | 130 平方米 | 1 |



SUITE BENEFITS

Junior Suite / Deluxe Suite:

- Daily breakfast
- One-way airport limousine service once per room per stay
- Daily laundry or pressing for up to 3 pieces*

2-bedroom Junior Suite / Grand Suite / JingAn Suite:

- Daily breakfast
- Twice one-way airport limousine service once per room per stay
- Daily laundry or pressing for up to 5 pieces*

* Terms and conditions apply

DINING & ENTERTAINMENT

PHÉNIX eatery & bar

Located on Level 2 of The PuLi Hotel and Spa and overlooking JingAn Park, PHÉNIX eatery & bar is rooted in the philosophy of “Life is about the ingredients” and presents Modern French cuisine inspired by the richness of seasonal natural ingredients. Our Executive Chef has embarked on a mission to give a new life to French cuisine, by revisiting old favourites with a modern refreshing twist. PHÉNIX also features an intimate yet vibrant lounge space, allowing guests to enjoy classic minimalist cocktails and an impressive French wine selection.

Long Bar & Library

On the Lobby Level and open all day, the Long Bar & Library are the ideal vantage point from which to indulge in the views across JingAn Park and to explore its extensive offering of a light breakfast, all-day refreshments and Asian specialties, Express Lunch, its famed Afternoon Tea or expertly curated and crafted cocktails and artisanal wines before or after dinner.

Garden Terrace

The Garden Terrace is the place to unwind amidst the lush green of JingAn Park. This 135sqm space can comfortably fit about 55 people. Plush sofas and comfy chairs seat a further 15 in sheltered comfort, beside a serene reflecting pool.

UR SPA - MODERN SCIENCE. ANCIENT HEALING.

- Comprehensive wellness and beauty treatments. Located on Level 3
- Comprehensively-equipped state-of-the-art health club
- Sauna
- Steam rooms
- Experiential showers
- Whirlpool
- 25-metre lap heated infinity pool overlooking JingAn Park
- The inaugural UR SPA in China

FACILITIES

- 24-hour Concierge Service from personalised itineraries featuring little-known Shanghai hotspots to transportation arrangements
- Fully equipped 24-hour business centre
- Wifi in public area

套房专享礼遇

特级套房 / 豪华套房:

- 每日早餐
- 入住期间可享一次机场单程接送服务
- 每日可享三件湿洗或熨烫*

双卧特级套房 / 经典套房 / 静安套房:

- 每日早餐
- 入住期间可享两次机场单程接送服务
- 每日可享五件湿洗或熨烫*

* 璞麗酒店保留最终解释权

餐饮服务

斐霓絲餐厅酒吧

斐霓絲餐厅酒吧位于璞麗酒店二楼，宾客在此品味佳肴美饌之时，亦可饱览静安公园宜人景致。秉持“料”理生活的理念，斐霓絲以丰富优质的天然食材为灵感源泉，本色呈现法式料理精髓。行政总厨擅长将经典与创新相结合，为传统法式菜品注入全新生命力。斐霓絲特别设有一个结合酒吧与休闲功能于一体的酒廊，提供经典鸡尾酒以及特别甄选的法定葡萄酒。宾客们可以在此悠然小酌，静享精选佳酿。

长吧及大堂书廊

位于酒店首层的长吧及大堂书廊是您尽情享受静安公园怡人景色的理想场所。酒吧全天开放，供应轻食早餐、全天候茶点、亚洲特色小食、简便午餐、享誉盛名的长吧下午茶、匠心精制鸡尾酒及晚餐前后的优选葡萄酒。

露天花园

与静安公园直接相连，带您远离城市中的疲惫与喧嚣，面积达135平方米，宽敞的55席露天花园备有舒适的沙发和座椅，带您进入另一个宁静而温馨的城市绿洲。

遥水疗 - 现代科技·古法护理

- 位于酒店三楼，提供一系列健康及美容疗程
- 配备先进的健身房
- 桑拿室
- 蒸汽室
- 体验式淋浴房
- 奈米微气泡按摩浴池
- 长达25米可俯瞰静安公园的无边恒温室内游泳池
- 国内原创品牌的遥水疗中心

其他设施

- 24小时礼宾服务提供上海热门景点及交通咨询
- 设施齐全的24小时商务中心
- 酒店公共区域均提供无线上网

EVENTS

The PuLi Hotel and Spa is the event venue of choice for many luxury brands and fortune 500 companies.





With numerous venues to choose from, guests can experience handcrafted service from tailor-made menus to programming assistance. Our venues include The Garden Terrace on Level 1, Level 2 PHÉNIX Private Dining Room, Level 3 Meeting Room and Level 26, a multi-functional space which can host exclusive and intimate events and gatherings for up to 150 guests.

会议及宴会设施

绝大部分的奢侈品牌及世界500强企业皆踊跃选择璞麗酒店作为举办会议及宴会活动的重点场地。

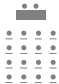
酒店提供多种场地可供宾客选择，包括位于一楼的露天花园、二楼斐霓絲餐厅专属包厢、三楼多功能会议室及26楼整层多功能空间，可举办多至150人的中型宴会；从定制菜单到协助策划活动，宾客将会享受到专属的奢华体验。

EVENT SPACE CAPACITY CHART
会议及宴会场地一览

| VENUE 场地 | SIZE 面积 |  THEATRE STYLE 剧院型 |  CLASSROOM 课桌型 |  U-SHAPED U型 |  BANQUET / ROUND TABLE 宴会 |  BOARD ROOM 董事会议 |  COCKTAIL 鸡尾酒会 |
|----------------------------------|------------|--|--|--|--|--|--|
| Level 1 一楼 | | | | | | | |
| Garden Terrace 露天花园 | 135 m² | - | - | - | - | - | 55 |
| Level 2 二楼 | | | | | | | |
| PHÉNIX Private Room 斐霓絲餐厅专属包厢 | 30 m² | - | - | - | - | 14 | - |
| PHÉNIX eatery & bar 斐霓絲餐厅酒吧 | 250 m² | - | - | - | 80 - 120 | - | - |
| Level 3 三楼 | | | | | | | |
| Meeting Room 三楼会议室 | 99 m² | 70 | 60 | 25 | 45 | - | 50 |
| Level 26 二十六楼 | | | | | | | |
| Room 1 一号会议室 | 35 m² | - | - | - | - | 10 | - |
| Room 2 二号会议室 | 70 m² | 50 | 30 | 25 | 35 | - | 50 |
| Room 3 三号会议室 | 70 m² | 50 | 30 | 25 | 35 | - | 50 |
| Room 4 四号会议室 | 36 m² | - | - | - | - | 10 | - |
| Room 1+2 一号+二号会议室 | 105 m² | 50 | 30 | 25 | 35 | - | 60 |
| Room 2+3 二号+三号会议室 | 140 m² | 100 | 60 | - | 70 | - | 100 |
| Room 3+4 三号+四号会议室 | 106 m² | 50 | 40 | 25 | 35 | - | 60 |
| Room 1+2+3 一号+二号+三号会议室 | 175 m² | 100 | 60 | - | 70 | - | 150 |
| Room 2+3+4 二号+三号+四号会议室 | 176 m² | 100 | 70 | - | 70 | - | 150 |
| Level 26 (1+2+3+4) 二十六楼全厅 | 211 m² | 100 | 70 | - | 70 | - | 150 |
| Outdoor Patio 户外观景阳台 | 95 m² | - | - | - | - | - | 50 |



EVENT SPACE FLOOR PLAN
会议及宴会场地平面图

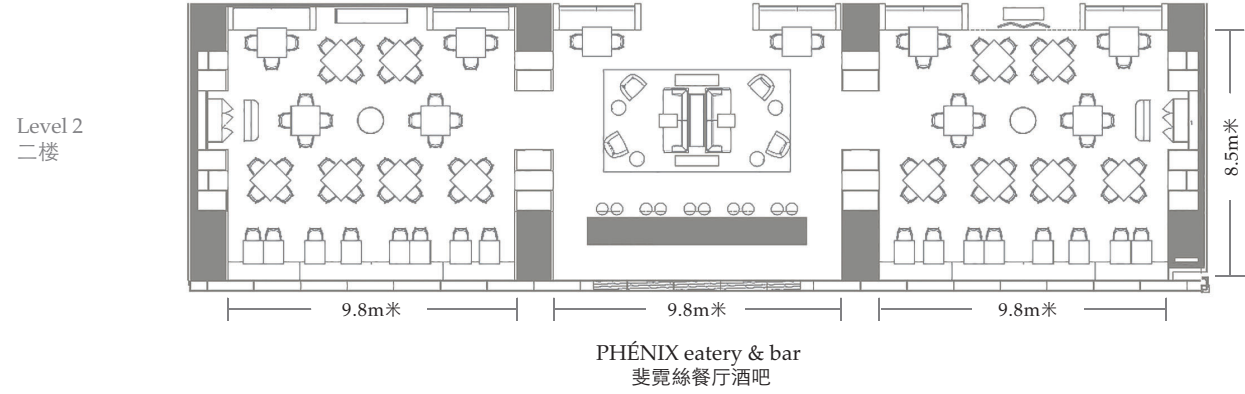
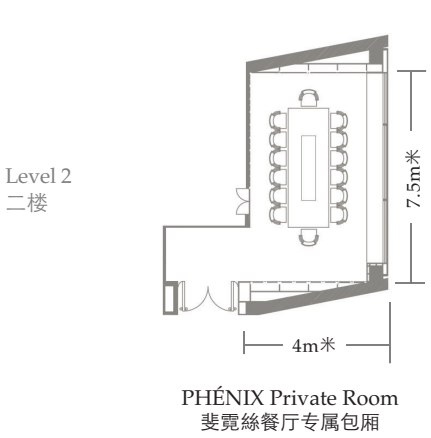
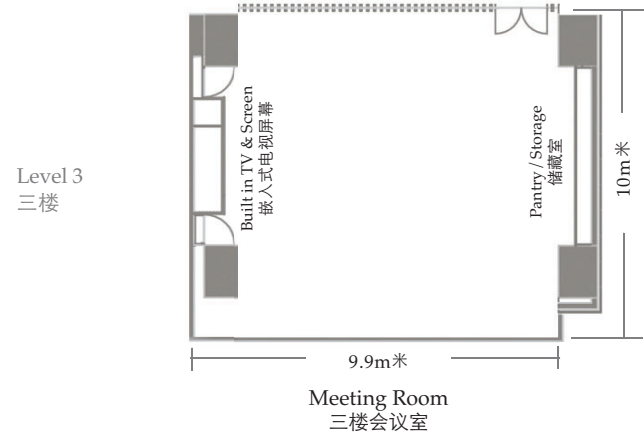
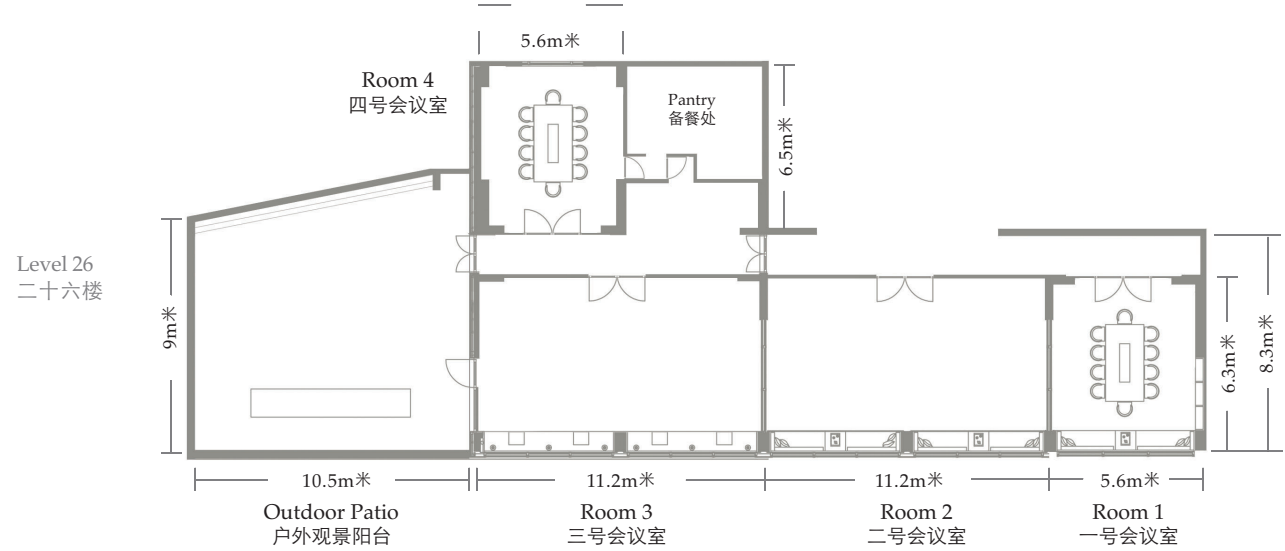



THE PULI HOTEL AND SPA

1 ChangDe Road, JingAn District, Shanghai 200040 China
T +86 21 3203 9999 F +86 21 3251 8989 reservations@thepuli.com www.thepuli.com
璞麗酒店 中国上海市静安区常德路1号 邮政编码 200040
GDS ACCESS CODES Amadeus: SHA812 Galileo: 97328 Sabre: 49224 Worldspan: 2812

A LUXURY HOTEL
Managed by
URBAN RESORT CONCEPTS

VIRTUOSO HOTELS & RESORTS

 A MEMBER OF
THE LEADING HOTELS
OF THE WORLD

PREFERRED SUPPLIER OF
SIGNATURE
TRAVEL NETWORK