



THE PULI



THE PULI HOTEL AND SPA 璞麗酒店

1 ChangDe Road, JingAn District, Shanghai 200040 China

中国上海市静安区常德路1号 邮政编码200040

T +86 21 3203 9999 F +86 21 3251 8989

information@thepuli.com

reservations@thepuli.com

www.thepuli.com

www.urbanresortconcepts.com



LOCATION

The PuLi Hotel and Spa is one of China's first luxury urban resorts, centrally located in the very heart of Shanghai's JingAn District, between the famous NanJing West Road and YanAn Middle Road. The 26-floor hotel has a prime location close to some of Shanghai's best business, shopping, sightseeing and entertainment areas and is accessible via a myriad of transportation options, including subway Line 2 connecting Shanghai Pudong International Airport and Hongqiao Airport, Line 7, and Line 14.

The views from The PuLi Hotel and Spa take in the greenery of JingAn Park and it is conveniently located next to the multi-use development Park Place. Park Place is a business landmark on NanJing West Road comprising a premium office tower, the RéeL Shanghai Department Store and The PuLi Hotel and Spa.

The PuLi Hotel and Spa is managed by Urban Resort Concepts. It is a member of The Leading Hotels of the World.

DIRECTIONS

- The PuLi Hotel and Spa is located 50 kilometres from Shanghai Pudong International Airport. A 45-minute drive from the airport, drive along the Main Expressway via LuPu Bridge to YanAn Highway. Exit at HuaShan Road.
- The PuLi Hotel and Spa is located 14 kilometers from Hongqiao International Airport. A 25-minute drive from the airport whilst the Shanghai Railway Station is also a 25-minute drive.
- Subway Line 2 connects both Shanghai Pudong International Airport and Hongqiao Airport. Alight at JingAn Temple station for direct access to the RéeL Shanghai Department Store at Park Place.
- The Maglev High Speed Train from Pudong International Airport takes you to LongYang Road station on subway Line 2. Take this to JingAn Temple station, which will give you direct access to the RéeL Shanghai Department Store.

AWARDS & ACCOLADES

- PHÉNIX - One Diamond Restaurant by *The Black Pearl Restaurant Guide 2023*
- PHÉNIX - One Michelin Star Restaurant by *The Michelin Guide Shanghai 2023*
- Best Luxury Urban Resort Hotel in Shanghai *Hurun Best of the Best Awards 2023*
- Premium Spa in Shanghai Star Performer *Hurun Best of the Best Awards 2023*

位置

璞麗酒店是中国最早定位为“都会桃源”的奢华酒店，坐落于上海最繁华的市中心“静安区”，位于南京西路与延安中路之间的常德路1号。酒店拥有优越的地理位置，毗邻众多甲级写字楼、顶级购物中心、观光景点及娱乐场所。酒店所在位置交通便捷，直通地铁2号线、7号线与14号线静安寺站，其中地铁2号线贯穿上海浦东国际机场和上海虹桥国际机场。

酒店环抱静安公园的怡人景色，并连接静安区的地标—越洋广场，此商用综合项目由甲级办公楼、芮欧百货与璞麗酒店三个独立项目组合而成。

璞麗酒店是由Urban Resort Concepts(URC)酒店管理公司经营，同时也是美国立鼎世酒店集团公司 (The Leading Hotels of the World) 的成员之一。

交通

- 璞麗酒店距离上海浦东国际机场约50公里。沿机场高速直达卢浦大桥，并从延安高架华山路口驶出，车程仅45分钟。
- 璞麗酒店距离上海虹桥国际机场约14公里，车程仅25分钟。同时距上海火车站也仅25分钟车程。
- 地铁2号线连接上海浦东国际机场和上海虹桥国际机场，抵达静安寺站，直通越洋广场内的芮欧百货。
- 上海浦东国际机场磁悬浮高速列车抵达龙阳路站，换乘地铁2号线到达静安寺站，直通芮欧百货。

奖项和荣誉

- 斐霓絲餐厅 —— 黑珍珠一钻餐厅 / 2023年度上海黑珍珠餐厅指南
- 斐霓絲餐厅 —— 米其林一星餐厅 / 2023年度上海米其林指南
- 最青睐的上海地区奢华城市度假酒店 / 胡润百富2023至尚优品
- 暹水疗 —— 上海高端 SPA 最佳表现 / 胡润百富2023至尚优品

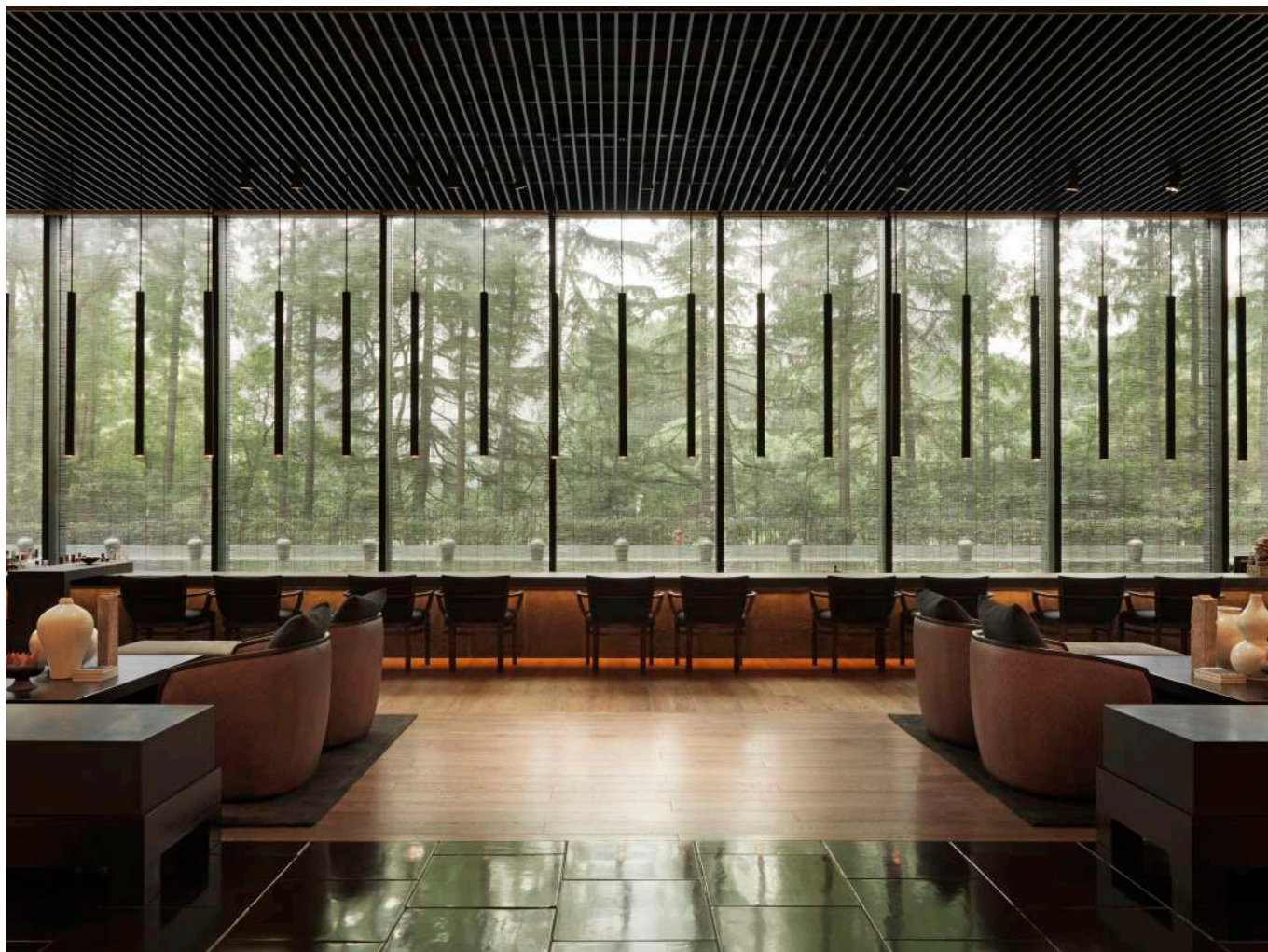

ACCOMMODATION

- 193 rooms and 36 suites
- Flat screen LED television sets
- Bang & Olufsen BEOPLAY wireless speaker
- Nespresso machines
- Personal safes
- Wifi throughout the hotel
- Rainforest showers
- Bathtubs with stunning views over the Shanghai skyline and JingAn Park
- Automated sunshades, temperature adjustments and monitor system in every room
- Stocked mini-bars

Room Category	Size	No. of Rooms
Deluxe King	45 sqm	71
Deluxe Twin	45 sqm	20
Grand Room	47 sqm	84
Grand Studio	52 sqm	15
Junior Suite	50 sqm	13
Deluxe Suite	85 sqm	17
2-bedroom Junior Suite	102 sqm	3 (x 2 bedrooms)
Grand Suite	95 sqm	2
JingAn Suite	130 sqm	1

客房及套房

- 193间客房和36间套房
- 高画质平面液晶电视
- Bang & Olufsen BEOPLAY 无线扬声器
- Nespresso 全自动咖啡机
- 个人专属保险箱
- 酒店提供无线宽带网络
- 热带雨林淋浴房
- 浴缸紧邻落地玻璃窗，可饱览静安公园怡人景致及上海优美城市景观
- 每间房均配备自动遮光帘及高智能室内恒温节能操控系统
- 房价包含迷你吧

客房类别	客房面积	客房数目
豪华大床房	45平方米	71
豪华双床房	45平方米	20
经典客房	47平方米	84
经典豪华客房	52平方米	15
特级套房	50平方米	13
豪华套房	85平方米	17
双卧特级套房	102平方米	3 (x 2卧室)
经典套房	95平方米	2
静安套房	130平方米	1



SUITE BENEFITS

- Daily breakfast at PHÉNIX, Long Bar, your guest room or on the go.
- Early check-in and late check-out based on availability.
- 2 complimentary glasses of mocktails at Long Bar.
- One-way airport limousine service per room per stay, based on a minimum stay of consecutive two nights or above.
- Local Calls.
- Complimentary parking (1 car per room).
- Fully stocked mini-bar with daily replenishment.
- Use of meeting room for up to 2 hours per stay (up to 10 guests)
- Priority reservations at PHÉNIX, Long Bar and UR SPA.
- 15% off Personal Training service.
- 10% off Health Club retail items.
- CNY 200 SPA credit, not combined with other promotions.

DINING & ENTERTAINMENT

PHÉNIX

Located on Level 2 of The PuLi Hotel and Spa and overlooking JingAn Park, PHÉNIX is rooted in the philosophy of "Life is about the ingredients" and presents Modern French cuisine inspired by the richness of seasonal natural ingredients. Our Executive Chef has embarked on a mission to give a new life to French cuisine, by revisiting old favourites with a modern refreshing twist. PHÉNIX also features an intimate yet vibrant lounge space, allowing guests to enjoy classic minimalist cocktails and an impressive wine selection.

Long Bar & Library

On the Lobby Level and open all day, the Long Bar & Library are the ideal vantage point from which to indulge in the views across JingAn Park and to explore its extensive offering of a light breakfast, all-day refreshments and Asian specialities, Express Lunch, its famed Afternoon Tea or expertly curated and crafted cocktails and artisanal wines before or after dinner.

Garden Terrace

The Garden Terrace is the place to unwind amidst the lush green of JingAn Park. This 135sqm space can comfortably fit about 55 people. Plush sofas and comfy chairs seat a further 15 in sheltered comfort, beside a serene reflecting pool.

UR SPA - MODERN SCIENCE. ANCIENT HEALING.

- Comprehensive wellness and beauty treatments. Located on Level 3
- Comprehensively-equipped state-of-the-art health club
- Sauna
- Steam rooms
- Experiential showers
- Whirlpool
- 25-metre lap heated infinity pool overlooking JingAn Park
- The inaugural UR SPA in China

FACILITIES

- 24-hour Concierge Service from personalised itineraries featuring little-known Shanghai hotspots to transportation arrangements
- Fully equipped 24-hour business centre
- Wifi in public area

套房专享礼遇

- 每日早餐 (可选斐霓絲、长吧、客房送餐或外带盒)
- 提前登记入住及延迟退房 (视酒店房态而定)
- 可在长吧享用两杯无酒精鸡尾酒
- 机场单程豪华车接送服务 (连续入住两晚以上即享)
- 本地电话
- 免费停车 (每房限一辆)
- 客房迷你吧 (每日补充一次)
- 每次入住免费使用会议室两小时 (至多10位客人)
- 优先预订斐霓絲、长吧及暹水疗
- 私教课程85折优惠
- 健身中心零售商品九折优惠
- 人民币200元UR SPA消费额度, 不可与其他活动叠加

餐饮服务

斐霓絲

斐霓絲位于璞麗酒店二楼, 宾客在此品味美饌之时, 亦可饱览静安公园宜人景致。秉持“料”理生活的理念, 斐霓絲以丰富优质的天然食材为灵感源泉, 本色呈现法式料理精髓。行政总厨擅长将经典与创新相结合, 为传统法式菜品注入全新生命力。斐霓絲特别设有一个结合酒吧与休闲功能于一体的酒廊, 提供经典鸡尾酒以及特别甄选葡萄酒。宾客们可以在此悠然小酌, 静享精选佳酿。

长吧及书廊

长吧及书廊位于酒店一层, 揽静安公园绿荫, 全天候提供各类菜品。这里更为您准备了品种齐全的香槟和葡萄酒精选酒单、优雅的特调鸡尾酒, 以及精美可口的茶点小吃, 是用餐前后或闲暇时与好友举杯酌饮的雅致之选。

露天花园

毗邻静安公园, 带您远离城市中的疲惫与喧嚣, 面积达135平方米, 宽敞的55席露天花园备有舒适的沙发和座椅, 带您进入另一个宁静而温馨的城市绿洲。

暹水疗 – 现代科技古法护理

- 位于酒店三楼, 提供一系列健康及美容疗程
- 配备先进的健身房
- 桑拿室
- 蒸汽室
- 体验式淋浴房
- 奈米微气泡按摩浴池
- 长达25米可俯瞰静安公园的无边恒温室内游泳池
- 国内原创品牌的暹水疗中心

其他设备

- 24小时礼宾服务提供上海热门景点及交通咨询
- 设施齐全的24小时商务中心
- 酒店公共区域均提供无线上网

EVENTS

The PuLi Hotel and Spa is the event venue of choice for many luxury brands and fortune 500 companies.

With numerous venues to choose from, guests can experience handcrafted service from tailor-made menus to programming assistance. Our venues include The Garden Terrace on Level 1, Level 2 PHÉNIX Private Dining Room, Level 3 Meeting Room and Level 26, a multi-functional space which can host exclusive and intimate events and gatherings for up to 150 guests.







会议及宴会设施

绝大部分的奢侈品牌及世界500强企业皆踊跃选择璞麗酒店作为举办会议及宴会活动的重点场地。

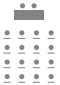
酒店提供多种场地可供宾客选择，包括位于一楼的露天花园、二楼斐霓絲专属包厢、三楼多功能会议室及26楼整层多功能空间和户外观景露台，可举办多至150人的中型宴会；从定制菜单到协助策划活动，宾客将会享受到专属的奢华体验。

EVENT SPACE CAPACITY CHART

会议及宴会场地一览

VENUE 场地	SIZE 面积	 THEATRE STYLE 剧院型	 CLASSROOM 课桌型	 U-SHAPED U型	 BANQUET / ROUND TABLE 宴会	 BOARD ROOM 董事会议	 COCKTAIL 鸡尾酒会
Level 1 一楼							
Garden Terrace 露天花园	135m ²	-	-	-	-	-	55
Level 2 二楼							
PHÉNIX Private Room 斐霓絲专属包厢	30m ²	-	-	-	-	14	-
PHÉNIX 斐霓絲	250m ²	-	-	-	80 - 120	-	-
Level 3 三楼							
Meeting Room 三楼会议室	99m ²	70	60	25	45	-	50
Level 26 二十六楼							
Room 1 一号会议室	35m ²	-	-	-	-	10	-
Room 2 二号会议室	70m ²	50	30	25	35	-	50
Room 3 三号会议室	70m ²	50	30	25	35	-	50
Room 4 四号会议室	36m ²	-	-	-	-	10	-
Room 1+2 一号+二号会议室	105m ²	50	30	25	35	-	60
Room 2+3 二号+三号会议室	140m ²	100	60	-	70	-	100
Room 3+4 三号+四号会议室	106m ²	50	40	25	35	-	60
Room 1+2+3 一号+二号+三号会议室	175m ²	100	60	-	70	-	150
Room 2+3+4 二号+三号+四号会议室	176m ²	100	70	-	70	-	150
Level 26 (1+2+3+4) 二十六楼全厅	211m ²	100	70	-	70	-	150
Outdoor Patio 户外观景露台	95m ²	-	-	-	-	-	50



EVENT SPACE FLOOR PLAN
会议及宴会场地平面图

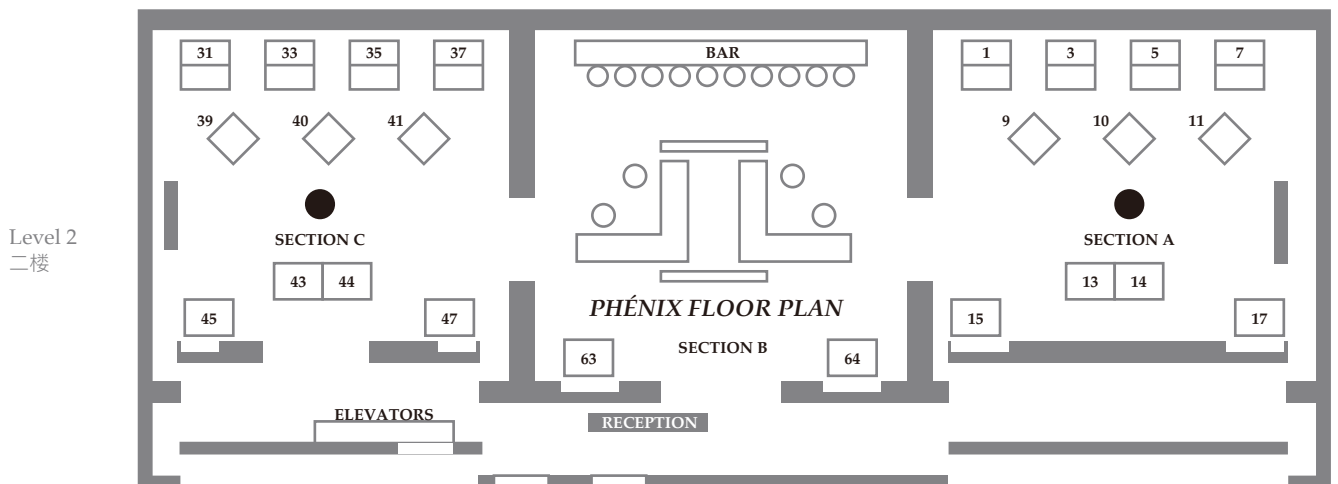
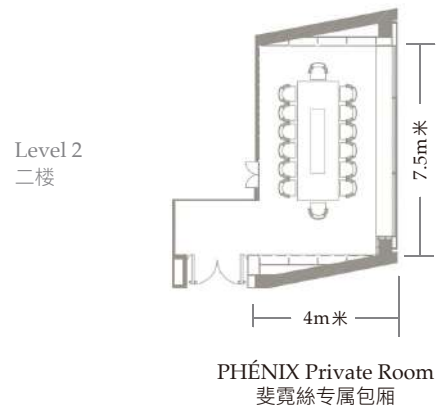
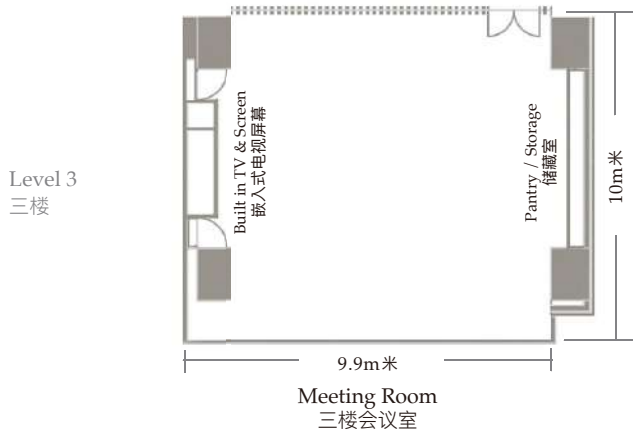
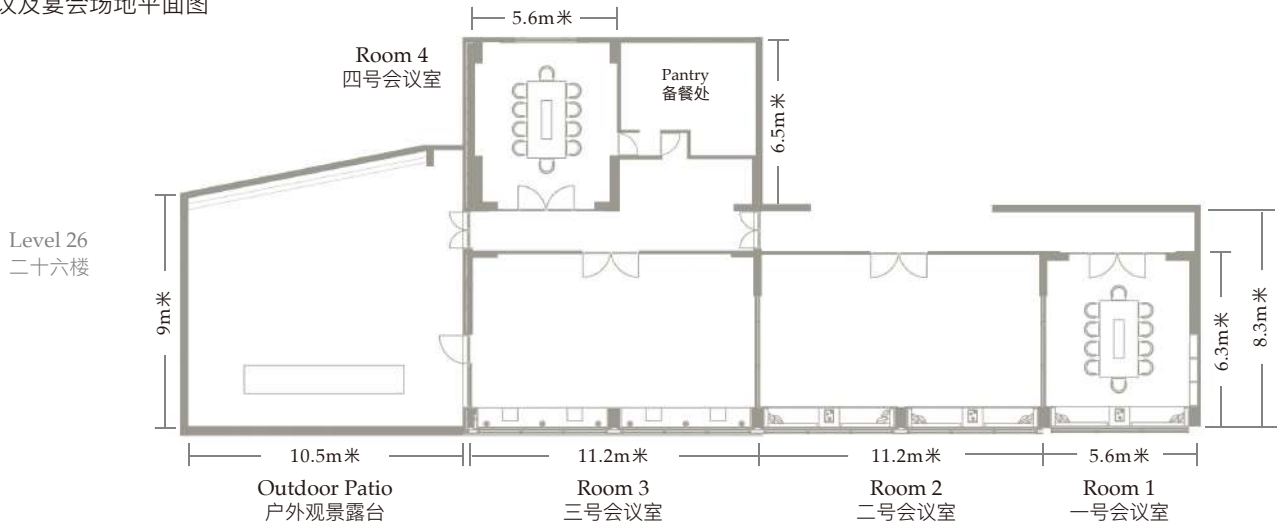



The PuLi Hotel and Spa

1 ChangDe Road, JingAn District, Shanghai 200040 China

T +86 21 3203 9999 F +86 21 3251 8989 www.thepuli.com

璞麗酒店 中国上海市静安区常德路1号 邮政编码200040

A LUXURY HOTEL
Managed by
URBAN RESORT CONCEPTS



A MEMBER OF
THE LEADING HOTELS
OF THE WORLD